

Road bridge over the River Nišava first prize winning solution

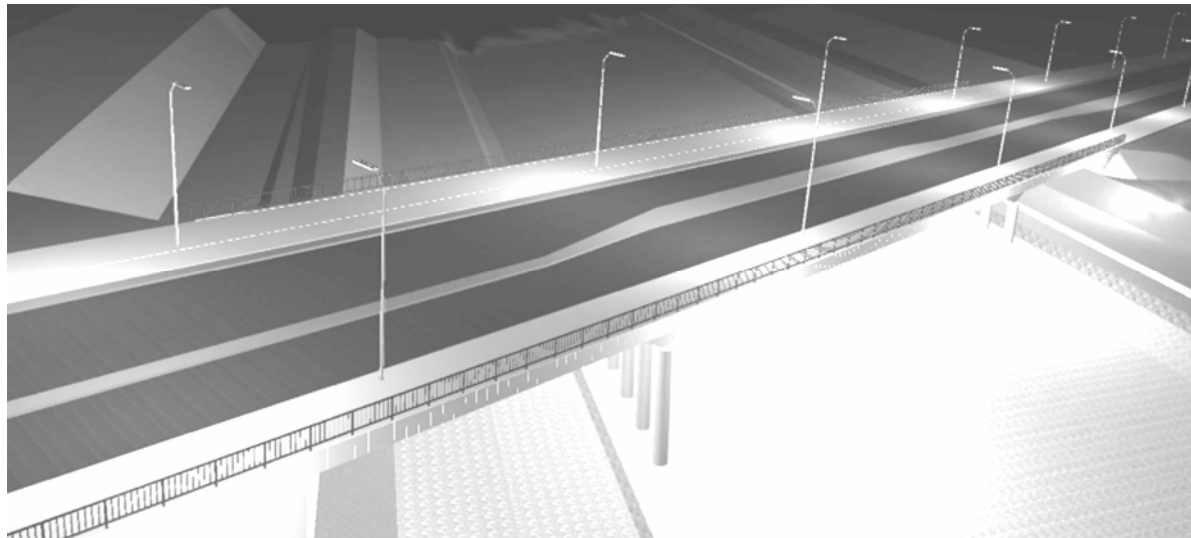

Authors: N. Spasojevic, A. Spasojevic, A. Kalac

Location



Location and general data

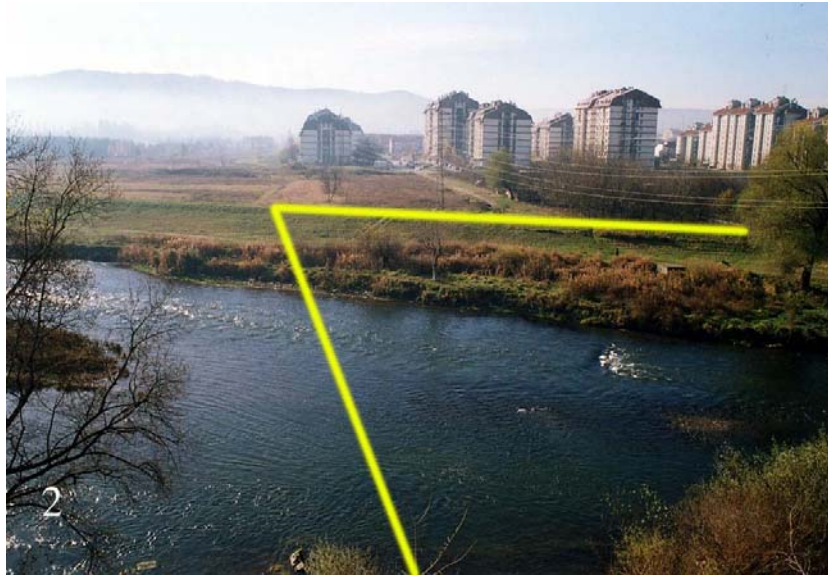

view from the right river bank

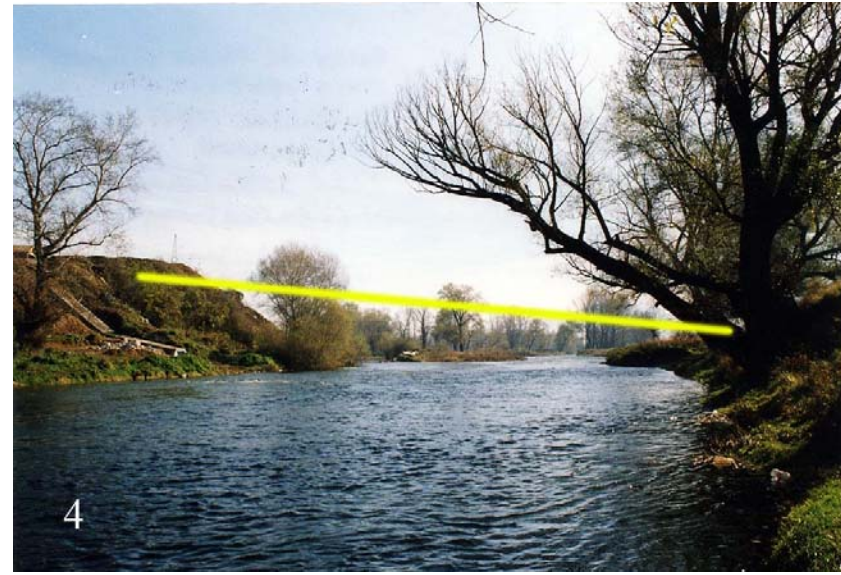

upstream view

One of important design conditions:

- design a solution so that the bridge can be built in two stages, with a first stage (approx. $\frac{1}{2}$ of the bridge width) allowing traffic flow in two lanes.

Designed solution: upstream view

Izgleđ mosta sa nizvodne strane

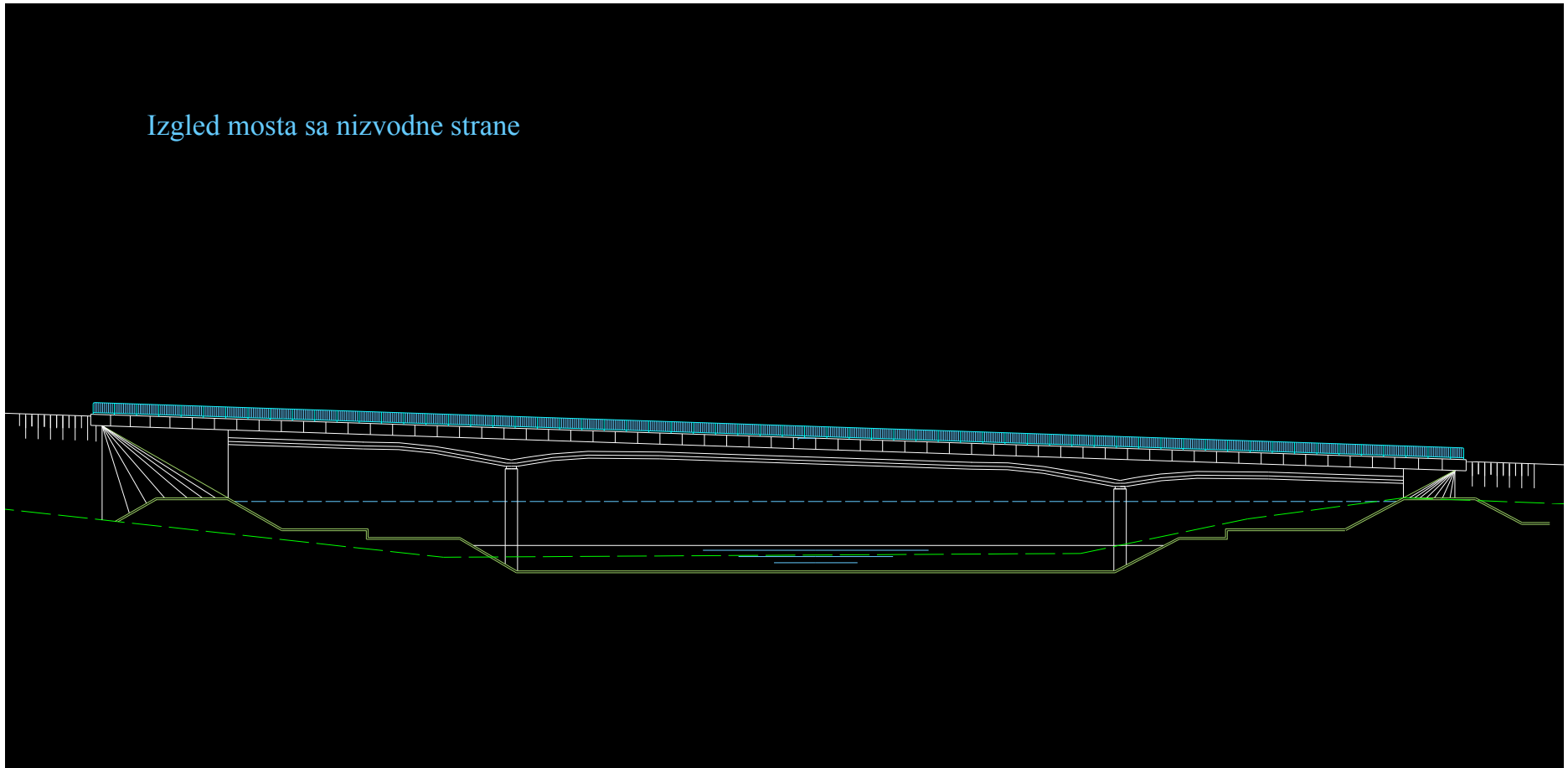

Designed solution: plan

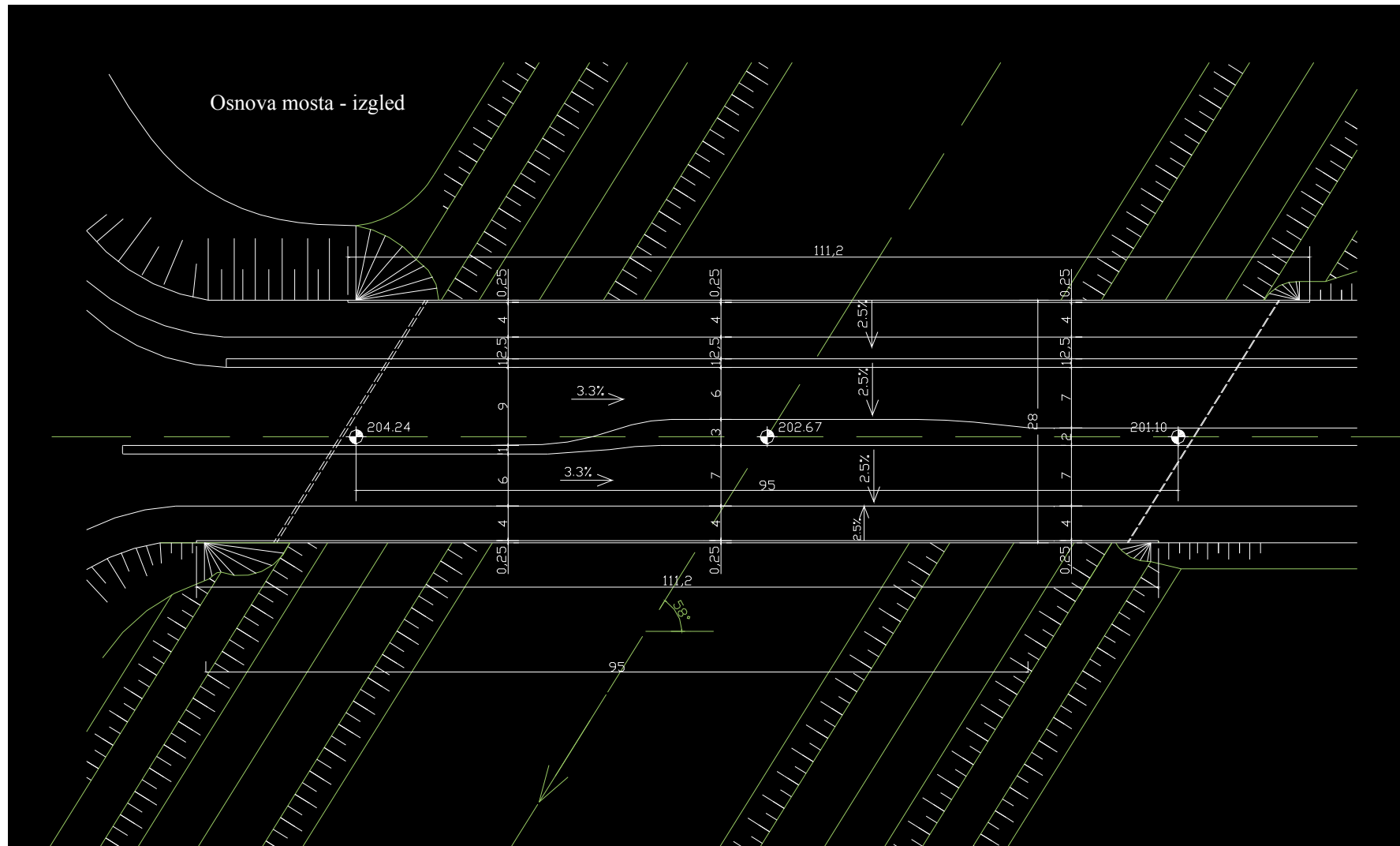

Designed solution: longitudinal section

Dispozicija mosta
podužni presek po niveleti

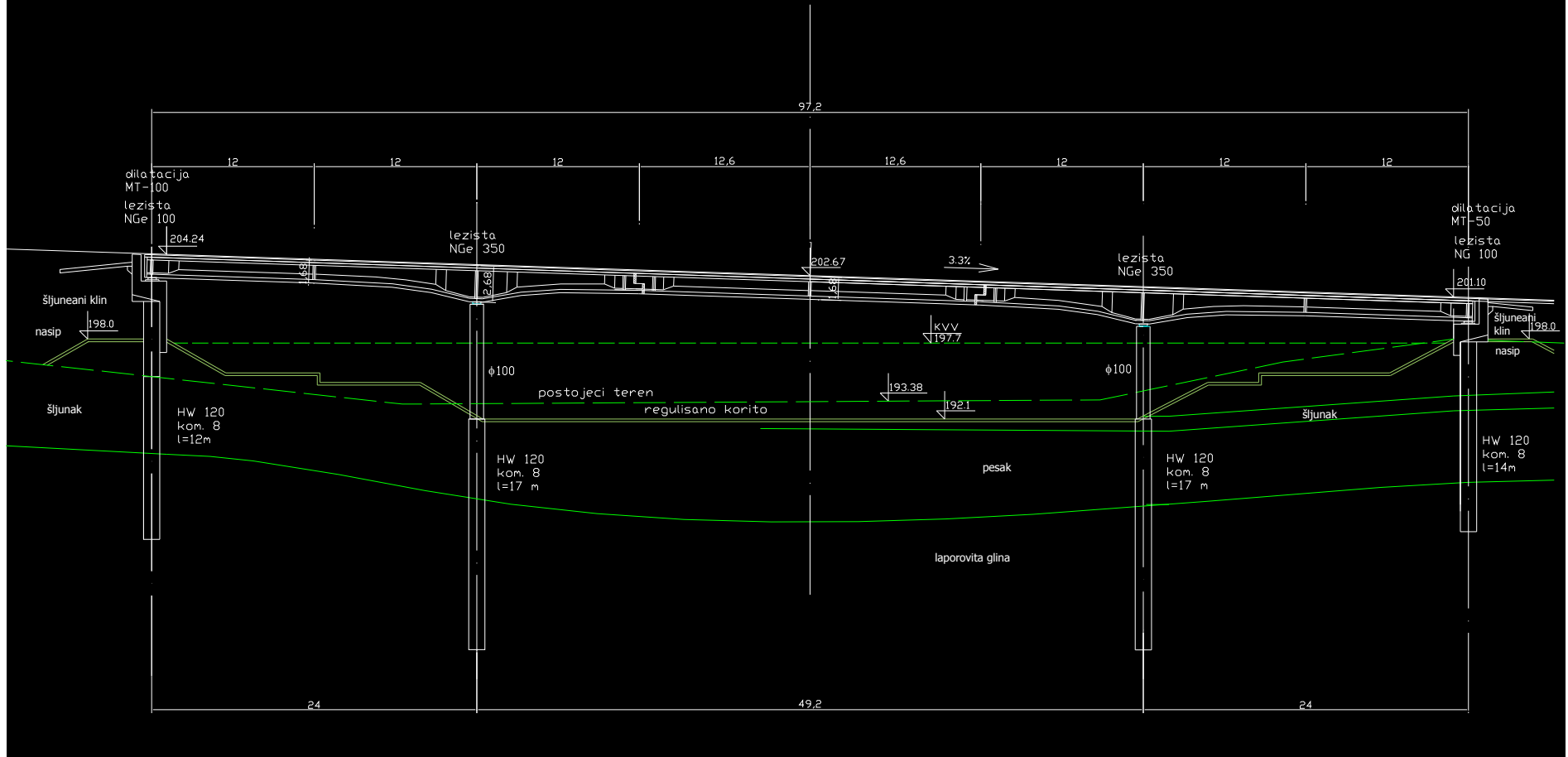

Designed solution: plan section

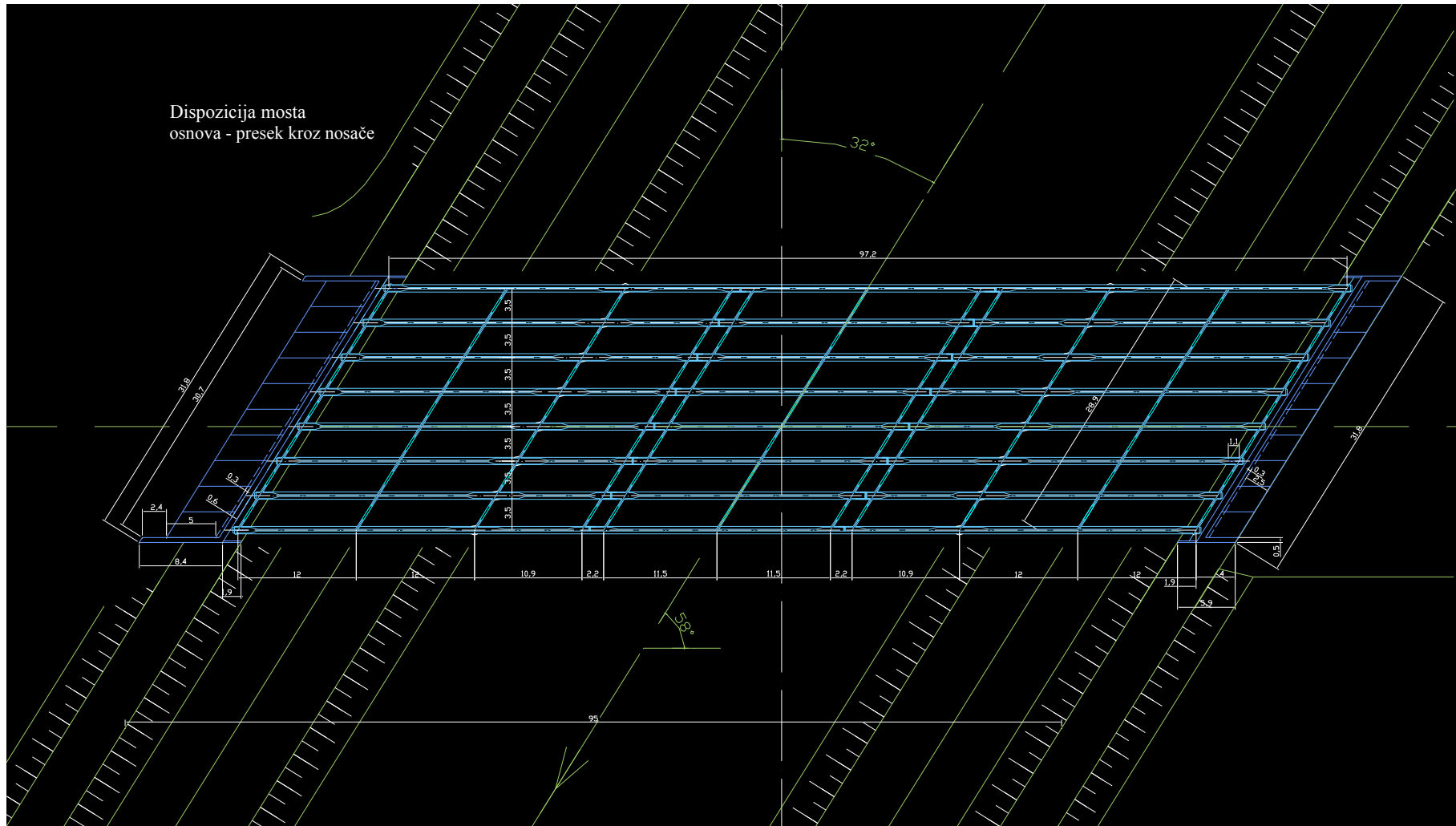

Designed solution: cross section

Poprečni presek mosta u polju

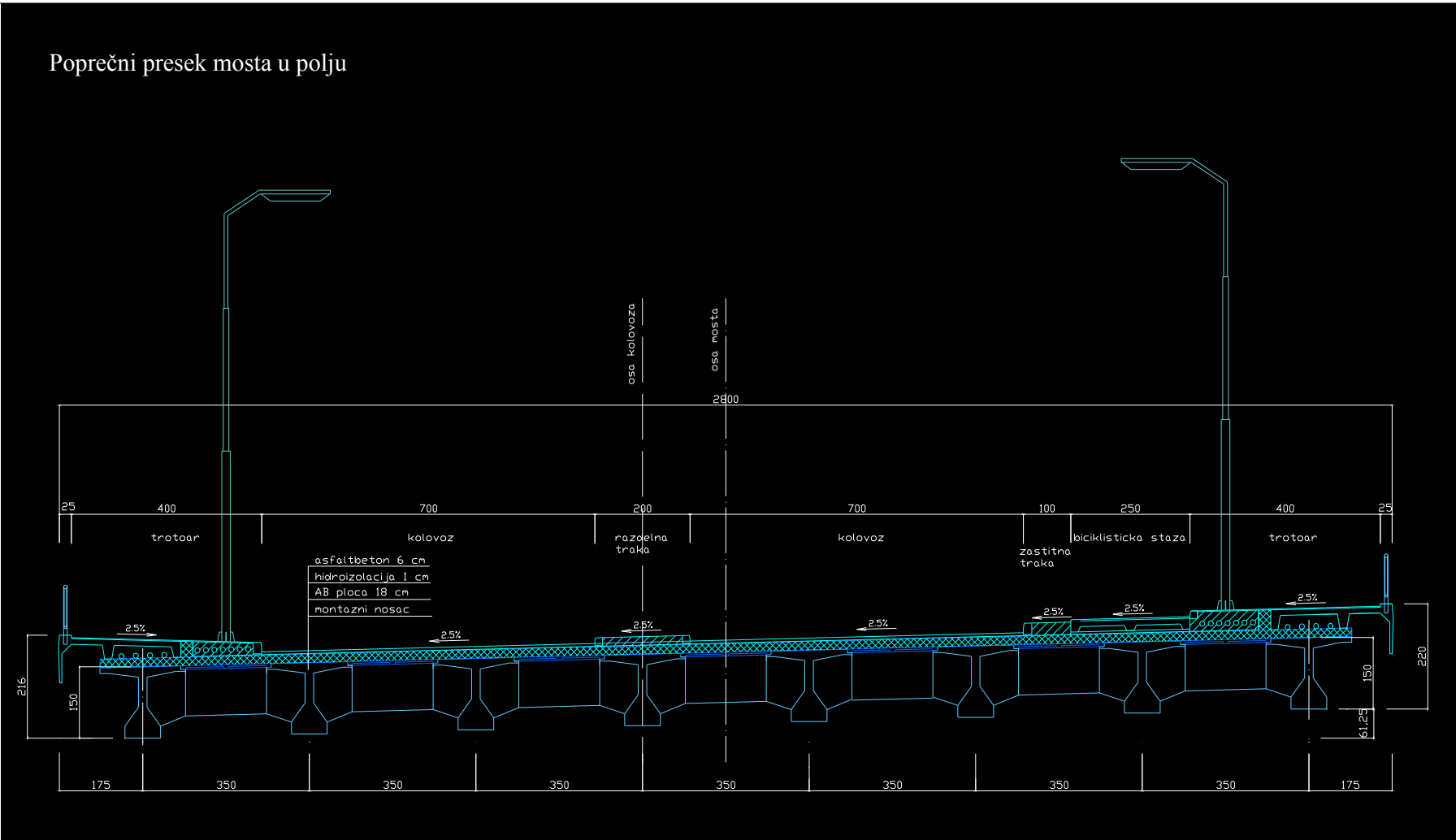

Designed solution: cross section for phase building (1/2)

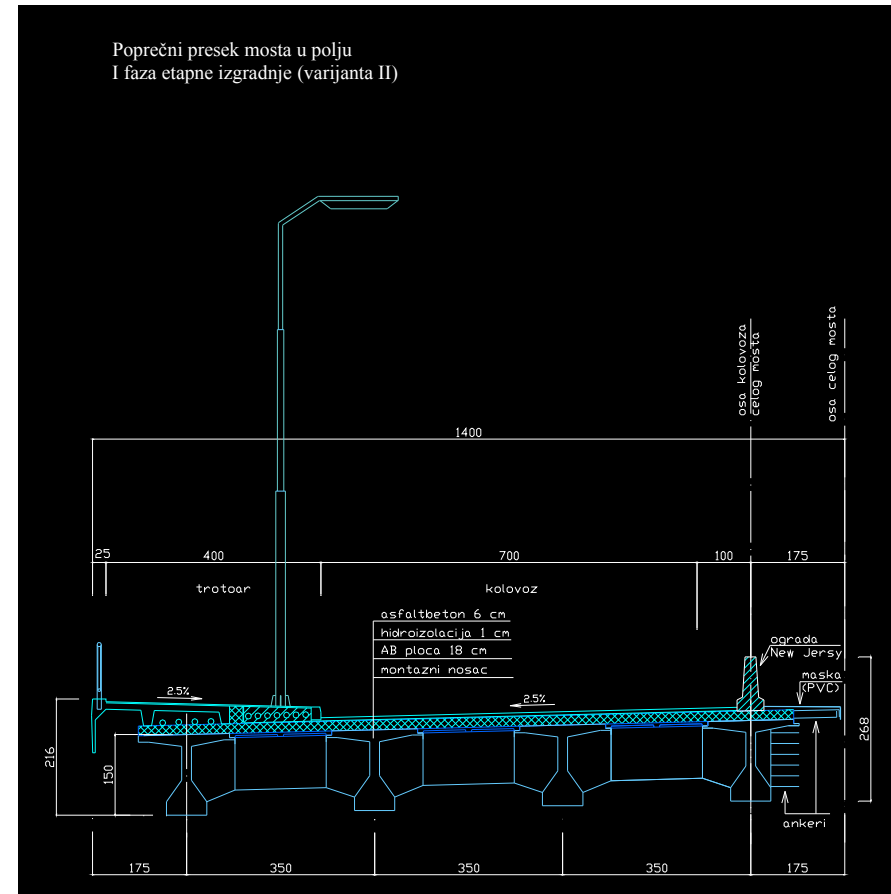
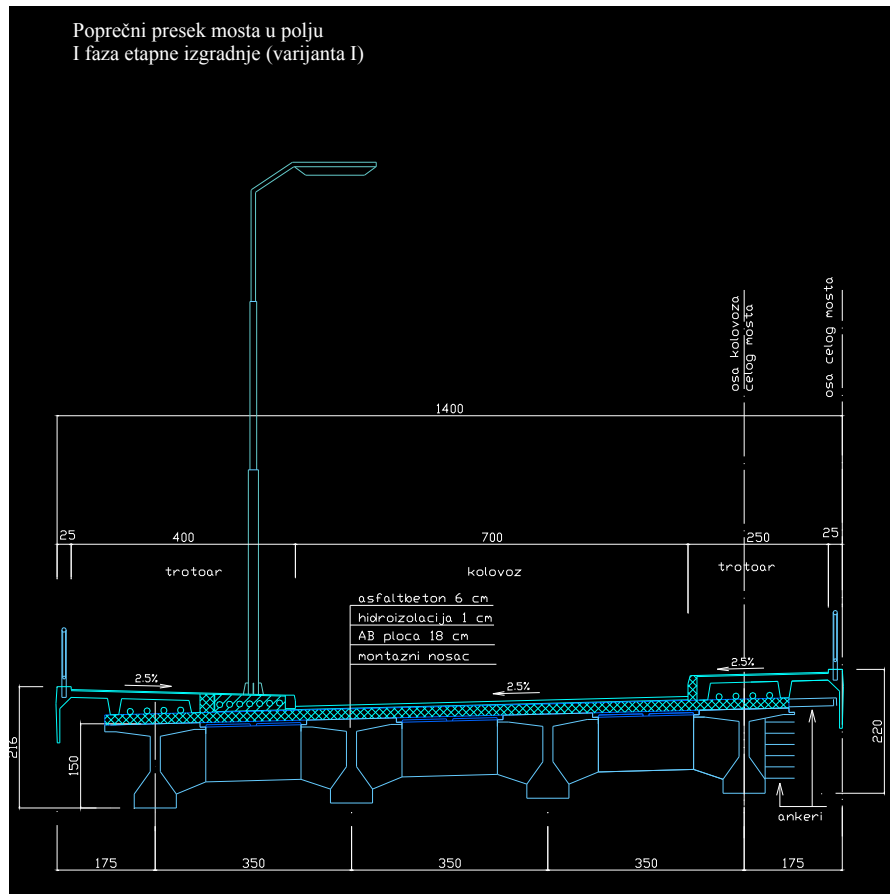

Designed solution: precast girders, cross section

poprečni presek montažnog nosaca u polju

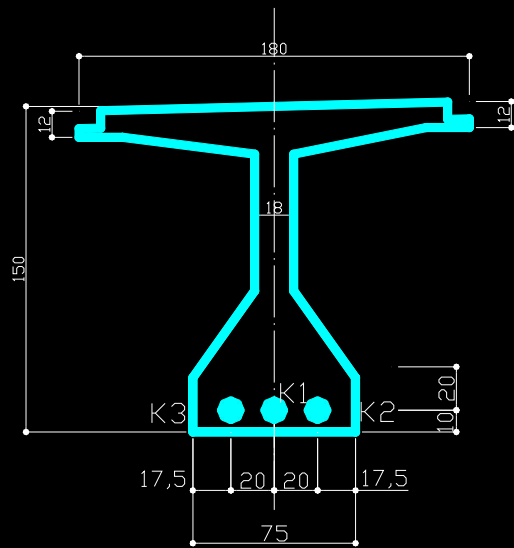

poprečni presek montažnog nosaca nad obalnim stubovima i na delu privremenih zglobova

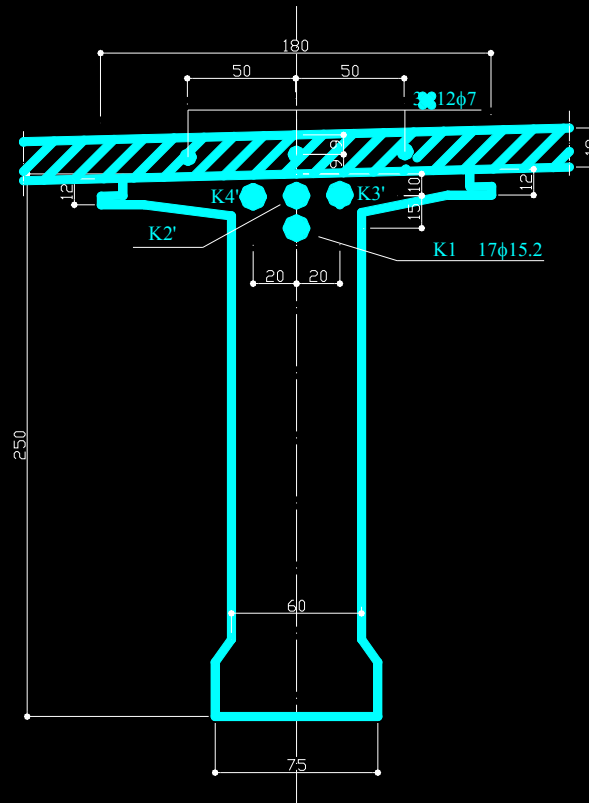

poprečni presek montažnog nosaca nad obalnim stubovima i na delu privremenih zglobova

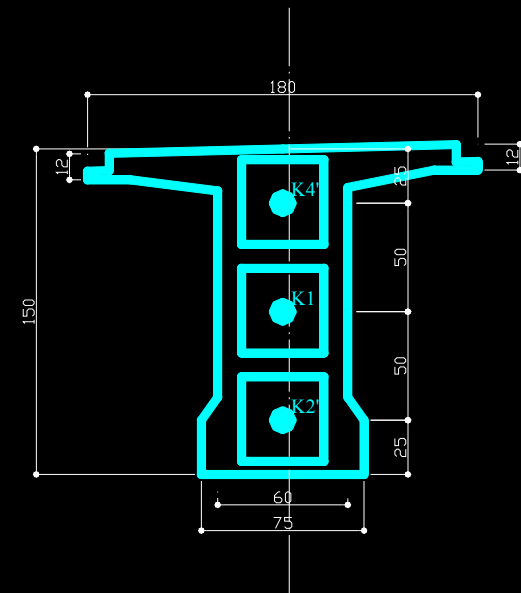

Designed solution: precasted girders

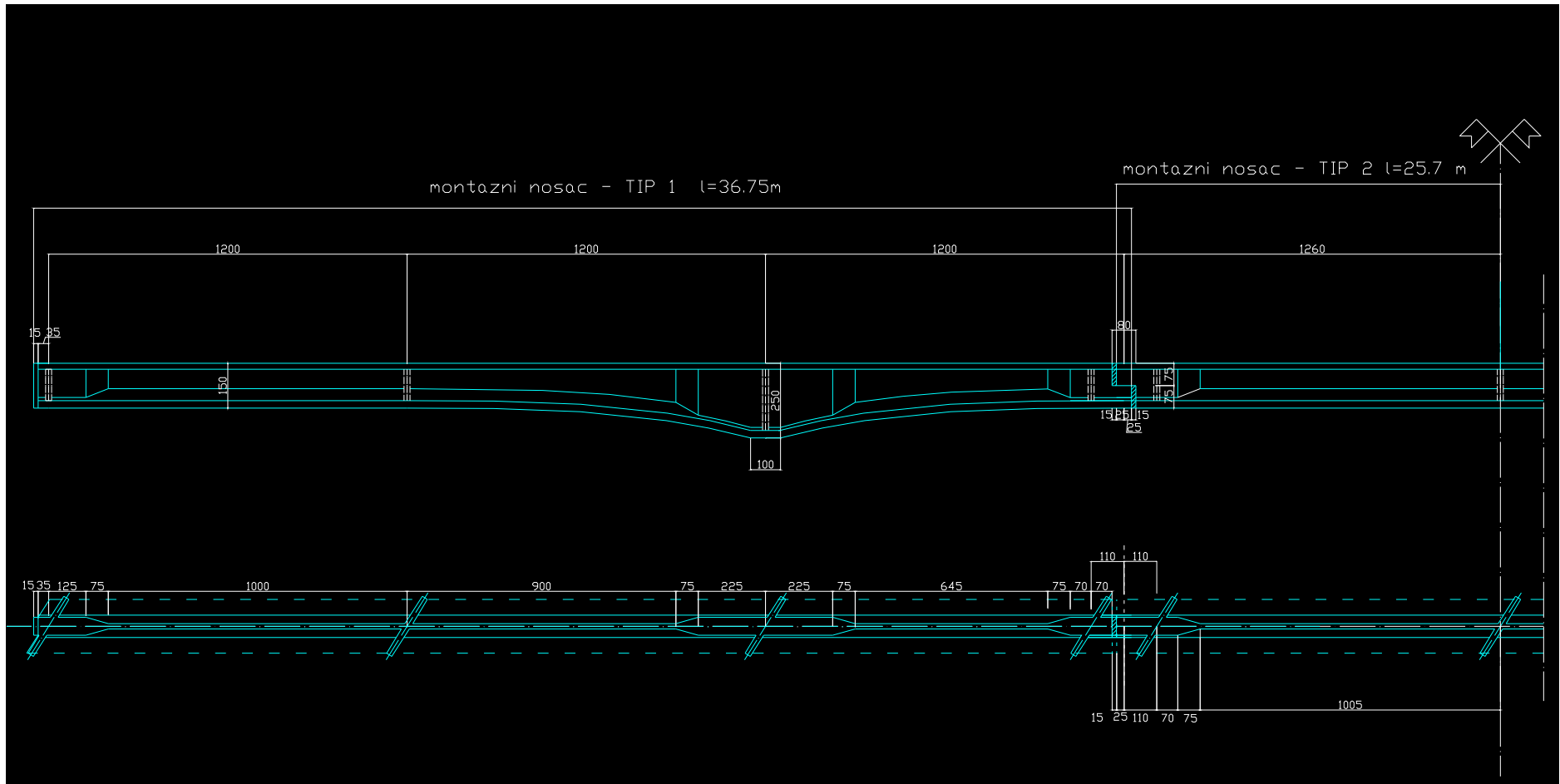

Calculation model

Računski model mosta - prostorni linijski sistem

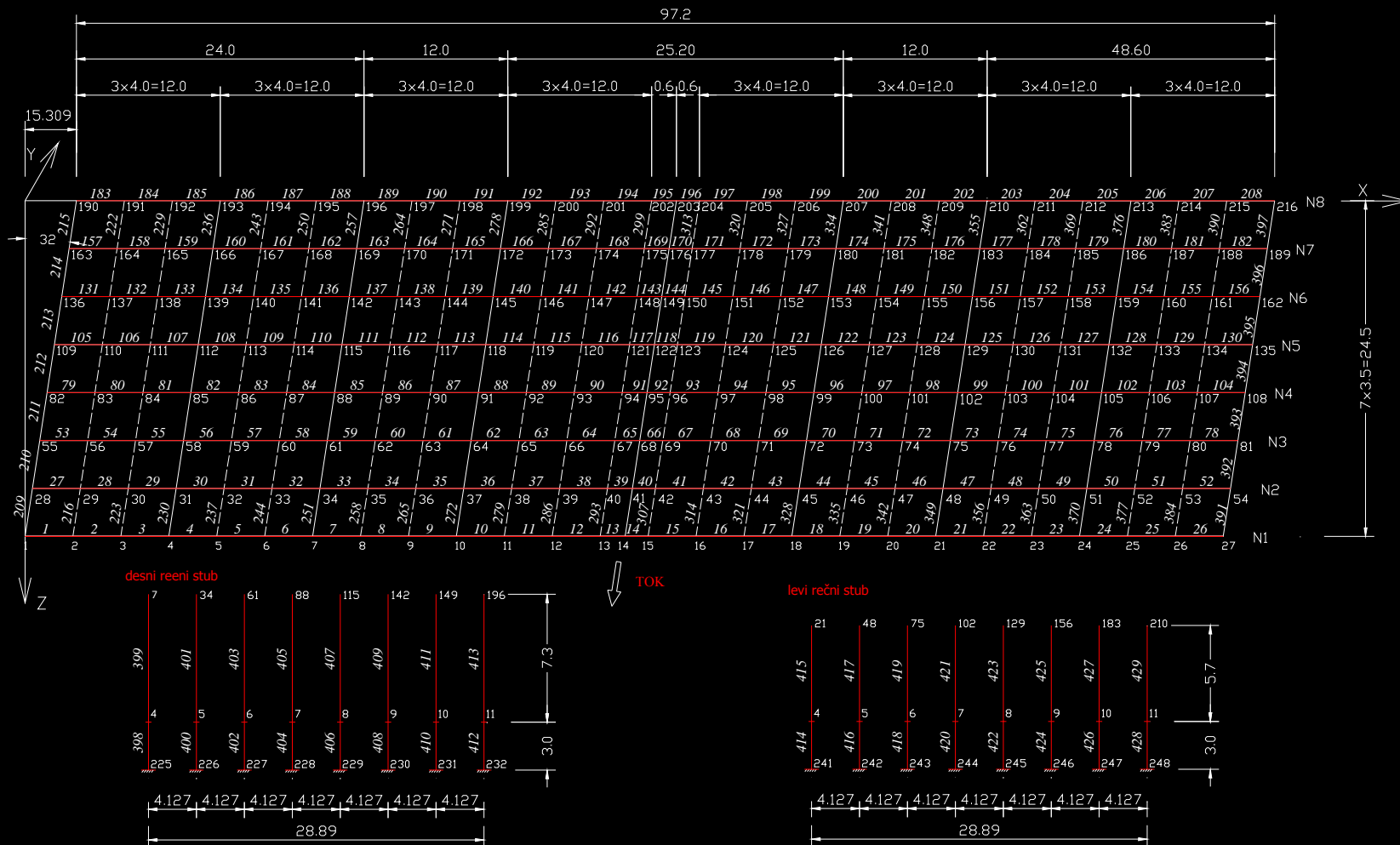

Designed stage building with precast elements

upstream view

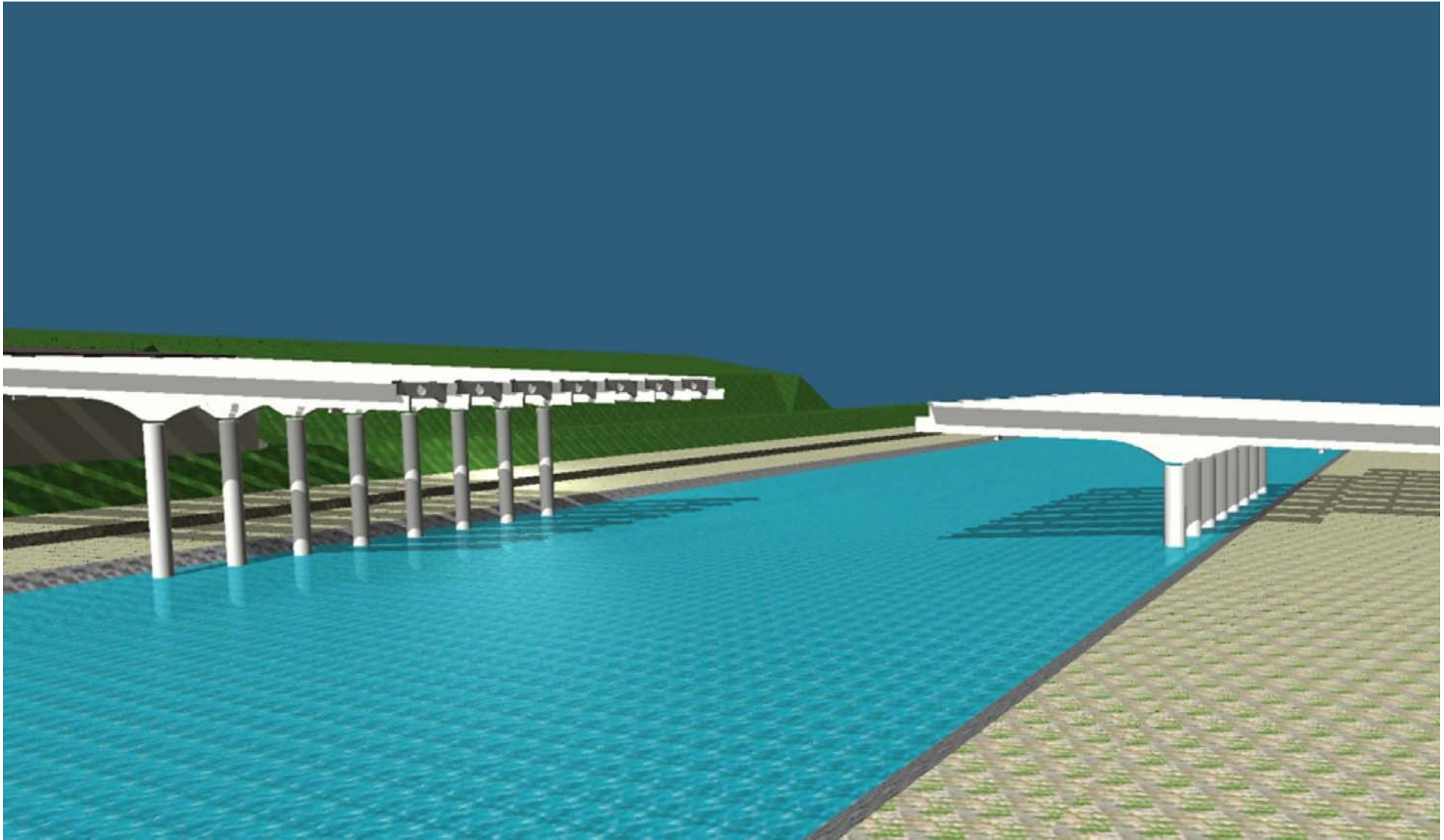

Designed stage building with precast elements

plan view

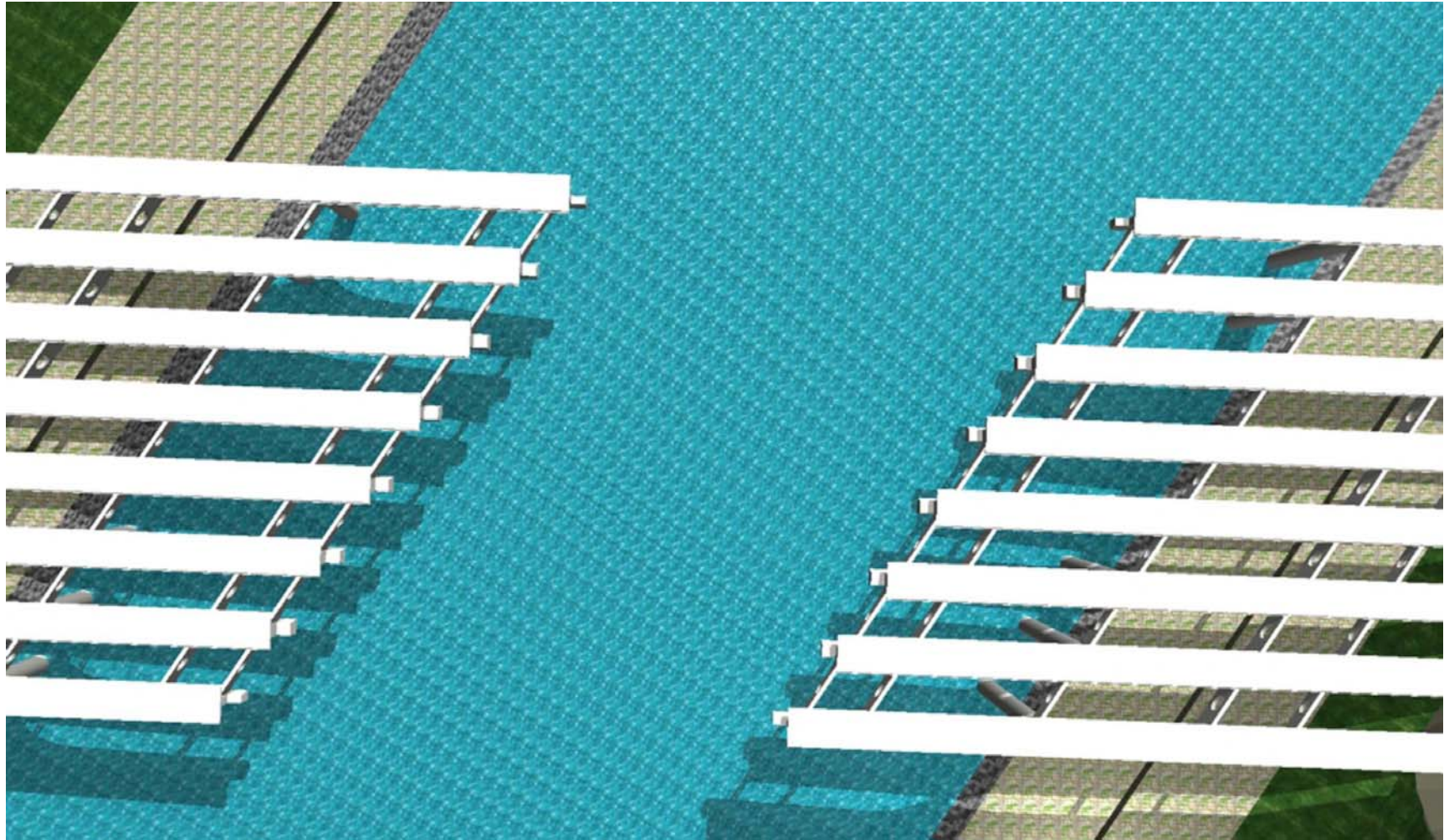

Designed stage building with precast elements

view along the bridge

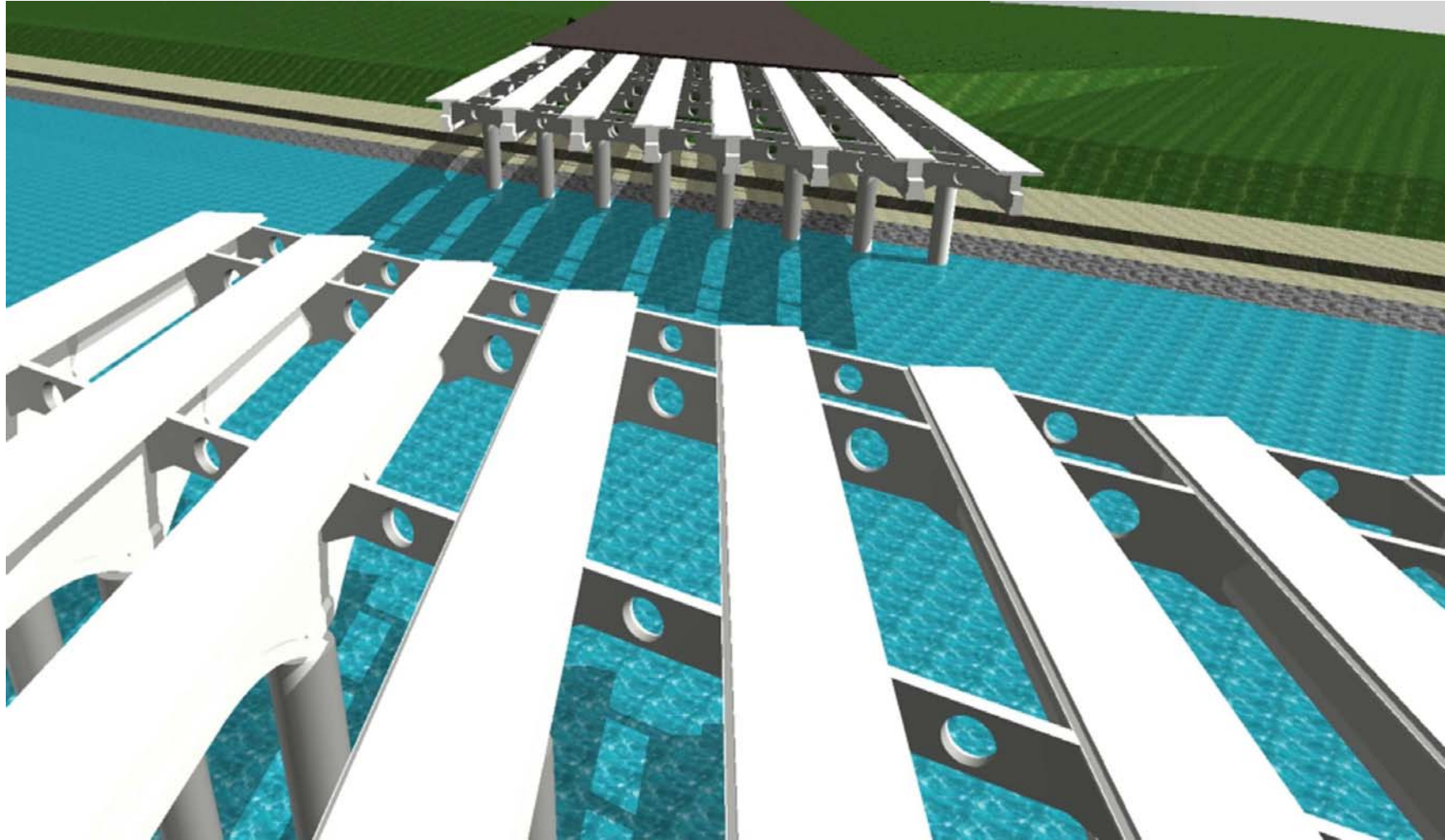

Designed stage building with precast elements

placing of girders in the mid-span

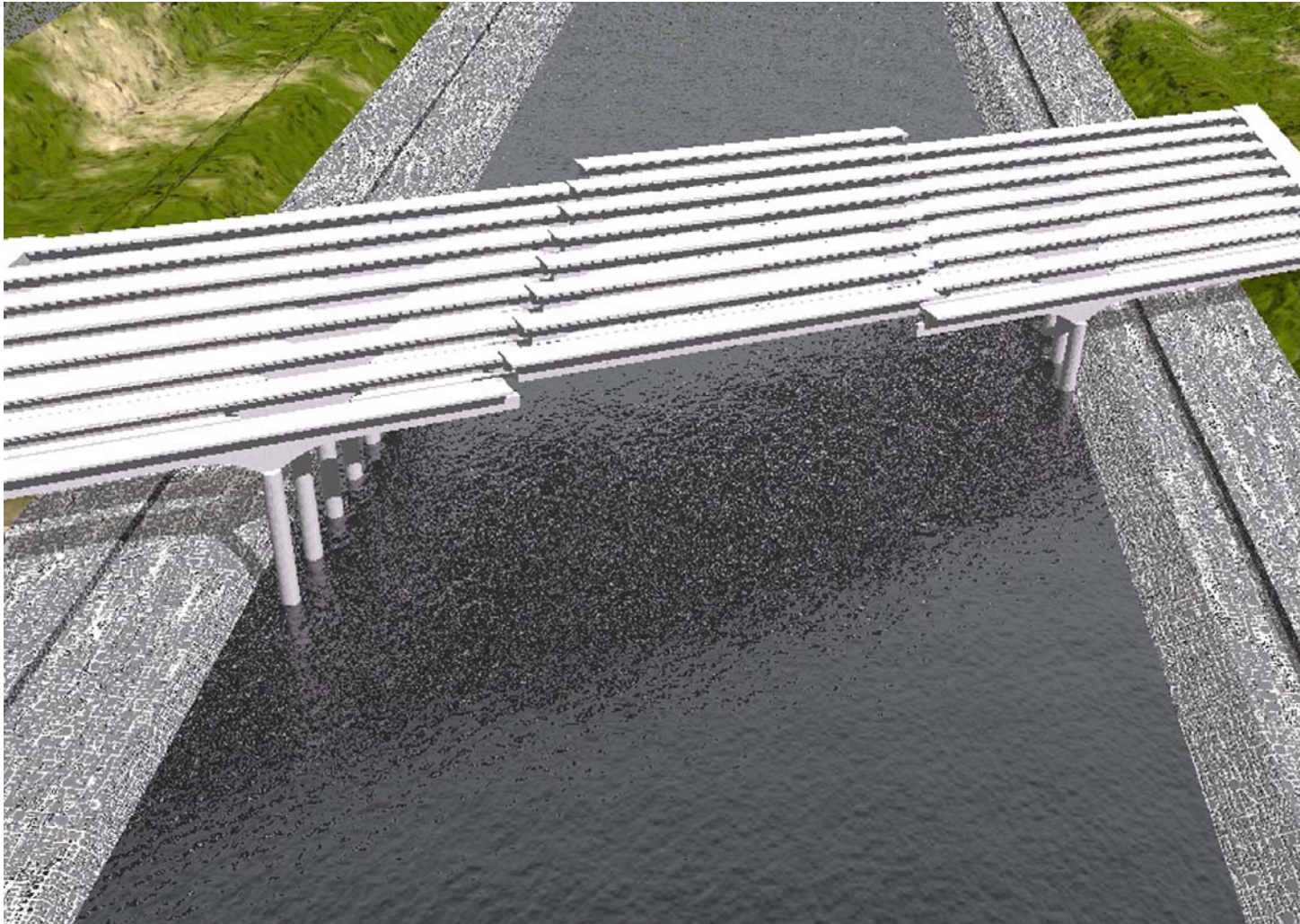

Designed stage building with precast elements

placing of girders in the mid-span

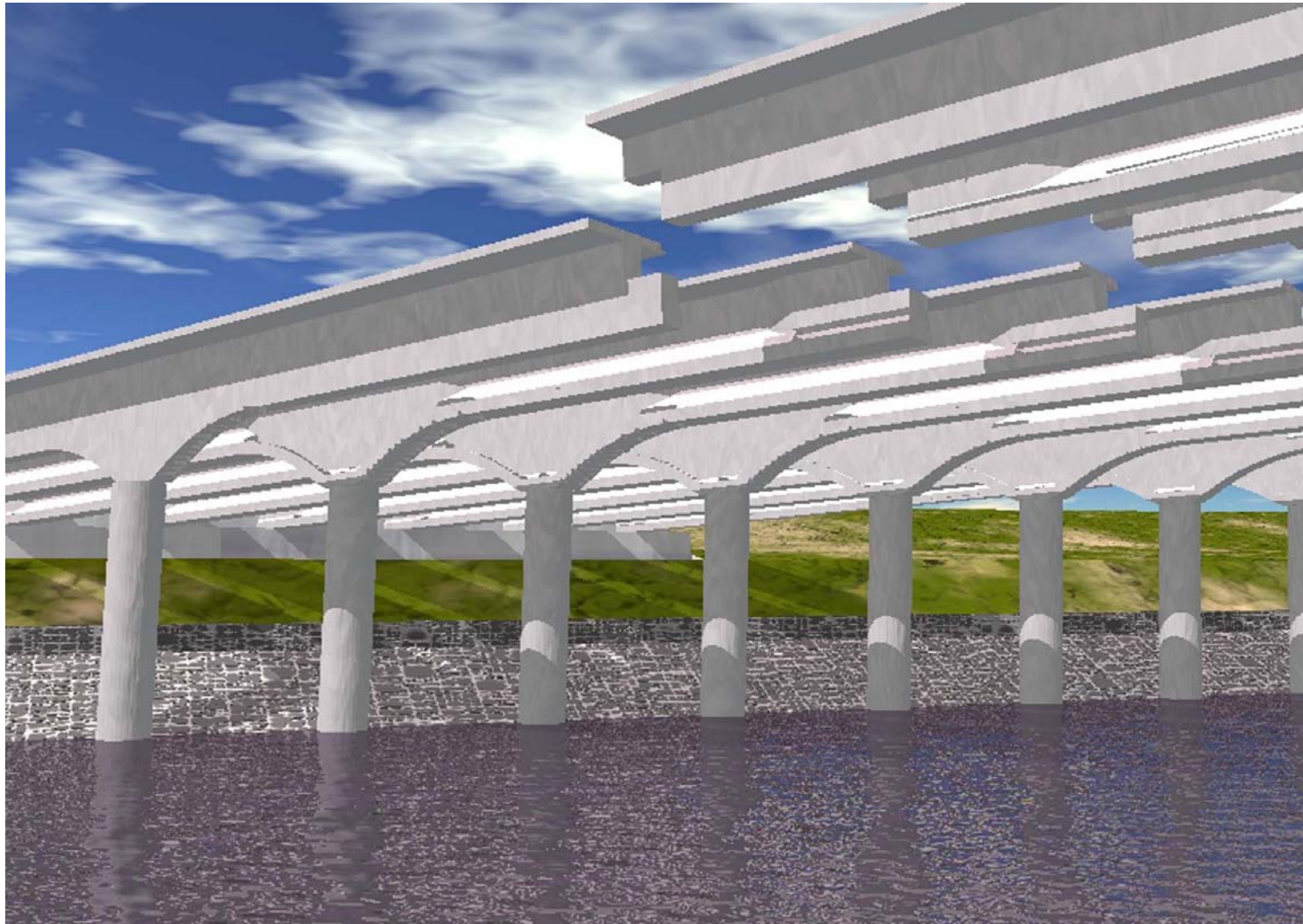

Designed stage building with precast elements

view of completed structure



Designed stage building with precast elements

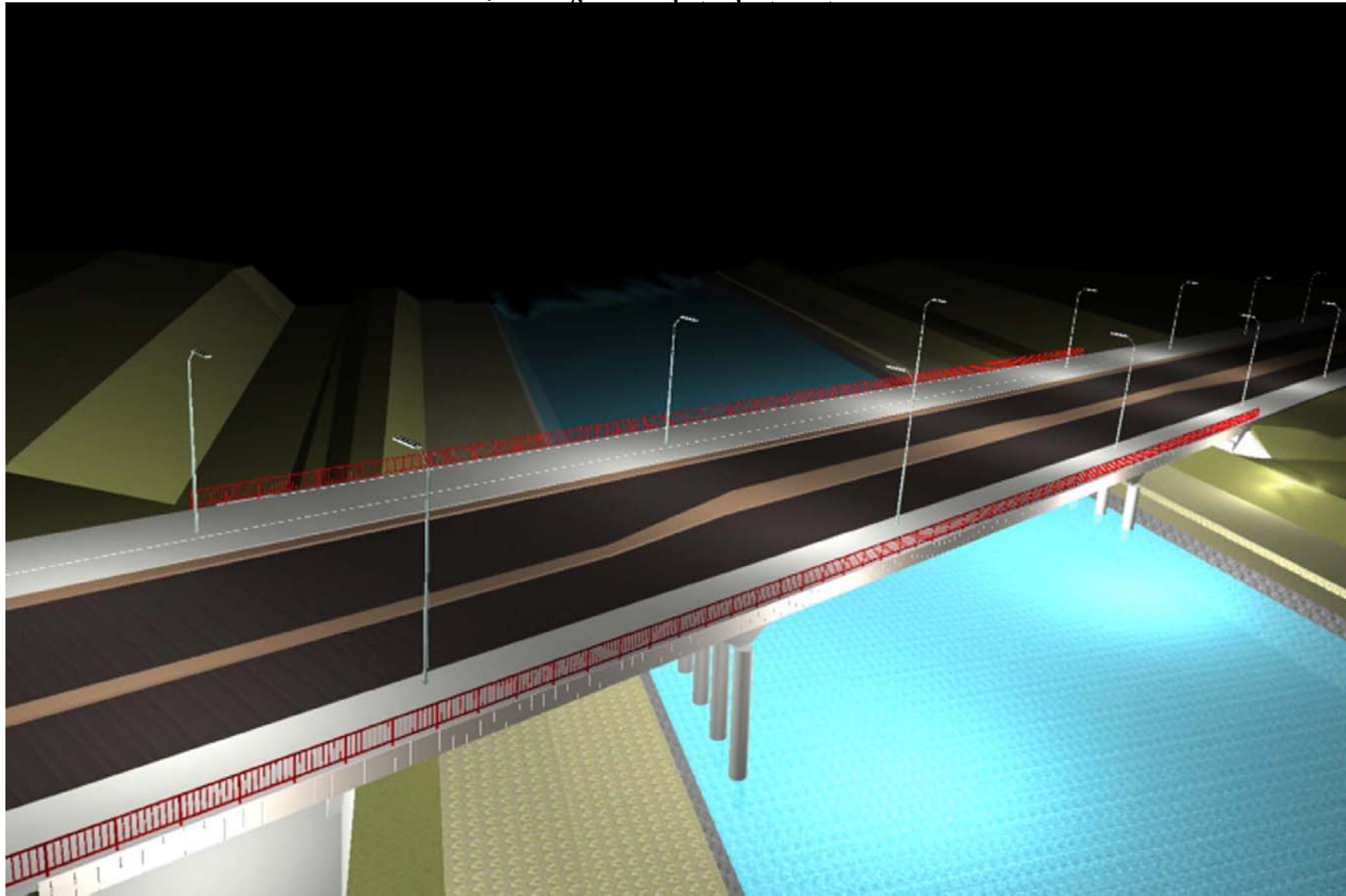

Designed stage building with precast elements

view of completed structure



A variant of design solution:
second prize winning solution

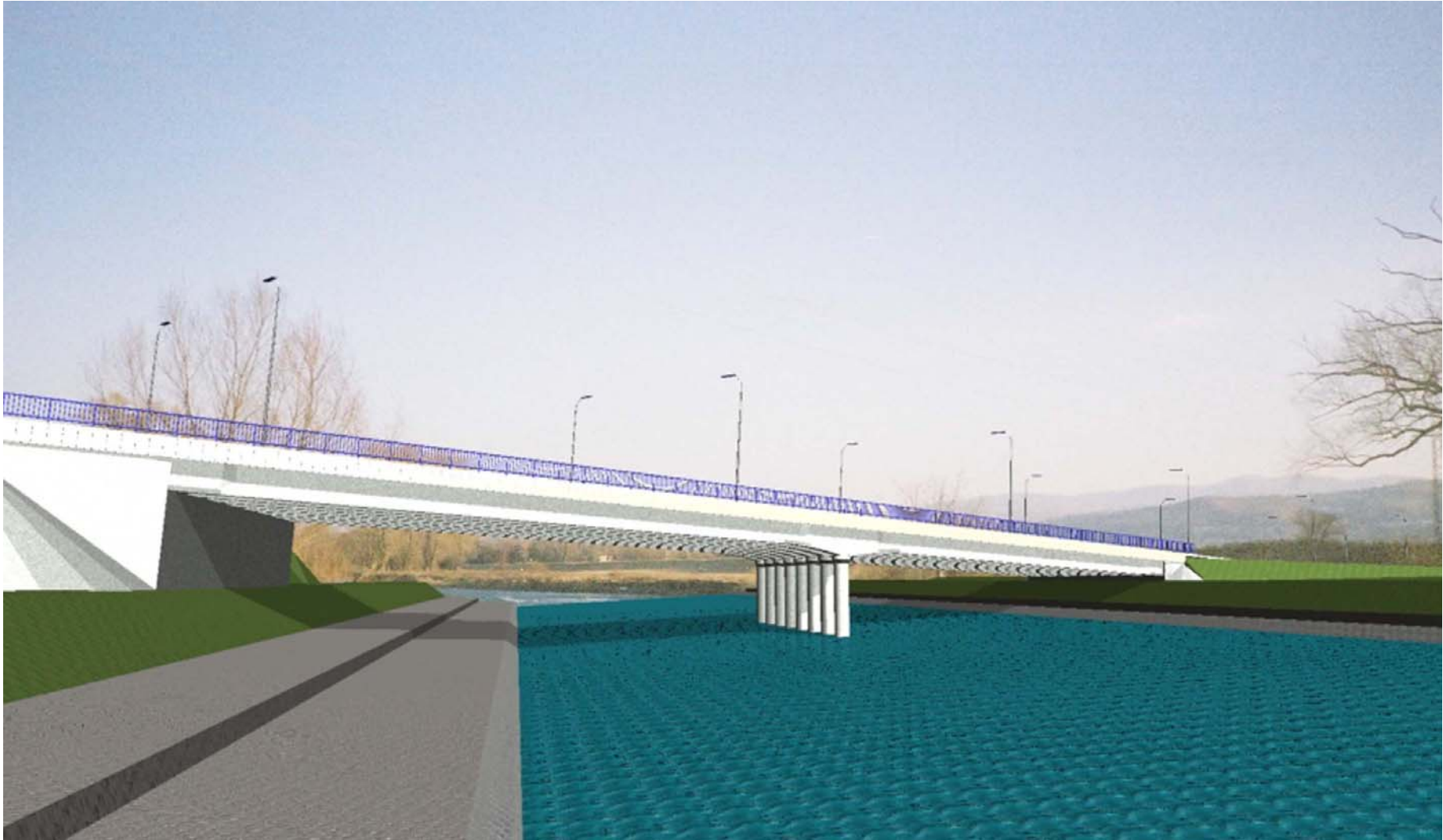

A variant of design solution:
second prize winning solution

